

## The Strawberry Vale

### Nature Play Perimeter Pathway

We are proposing that the existing natural play experiences on the Strawberry Vale playground be enhanced and expanded by developing a perimeter trail around the playground under and between the large trees, containing several natural and built play areas. These “Nature Play Areas” will provide more opportunities to connect children with nature through play and study and benefit their physical, emotional and academic development.

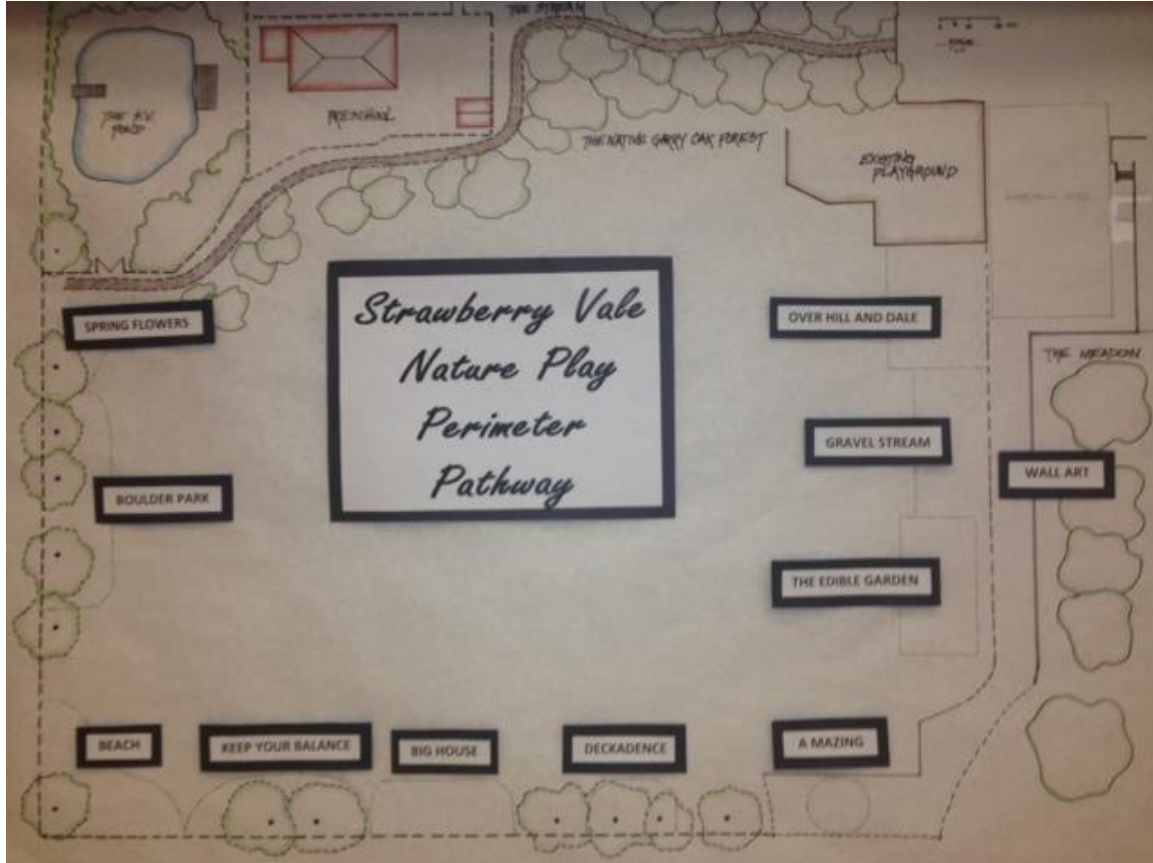

The Nature Play Perimeter Pathway has been divided into phases to facilitate planning, fund-raising, and construction.

## **The Strawberry Vale Nature Play Perimeter Pathway Phases**

### **A. Phase I**

1. **Wall Art** – Paint \$175.00 – Sealant \$125.00 - Paint Trays \$25.00 – Roller Sleeves \$25.00 – Pressure Washing \$150.00 Total \$500.00 Painting by students.
2. **The Maze** – Pressure Washing \$100.00 – Paint - \$80 – Maze Design and Layout \$200.00 – Roller Sleeves \$20 Total \$400.00 Painting by students.
3. **The Gravel Stream** – Gravel delivery \$100.00. Gravel spreading by students.
4. **Spring Flowers** – Bulbs – by donation. Planting by students.
5. **The Beach** – Site preparation - ? Sand – by donation – Driftwood –by donation Labour – volunteer/SD61? Sand spreading by students.
6. **The Boulder Park** – Site preparation - ? Gravel/ River Rock base– by donation – Labour – vounteer/SD61? Spreading by students.
7. **The Big House** – Acquire the logs by donation and store on site for bark stripping by Students.

### **B. Phase II**

1. **The Boulder Park** - Placement of the large boulders
2. **The Fallen Forest – Keep Your Balance** – Placement of balance logs.
3. **The Big House** – Placement of bench logs for seating and fire pit.
4. **The Beach** – Placement of the drift-wood, planting of beach grass by students.

### **C. Phase III**

1. **The Big House** – Construction of the entrance way frames.
2. **The Edible Garden** – Construction of gravel base, footings, fence, irrigation and beds. Placement of the Outdoor Ed Kiosk. Students to spread gravel, paint beds, fill beds with soil.
3. **Over Hill Over Dale** – Use sod and soil taken from garden site to build the berms.
4. **Deckadence** – Construction of the decks.

## The Strawberry Vale Nature Play Perimeter Pathway Features

### 1. Boulder Park

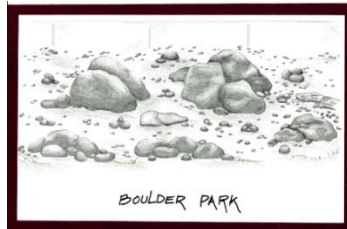

A place for students to explore, build, create, and learn.

### 2. The Beach



Sand dunes, sand grasses and driftwood where students can build shapes and create structures for imaginary play

### 3. Keep Your Balance - Fallen Forest Park



Large logs that can be climbed on and played by.

### 4. The Big House

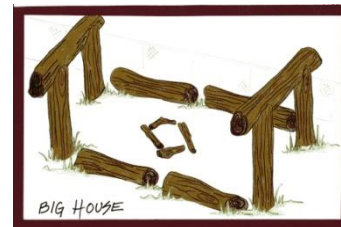

A frame work entrance of an ancient First Nations big house with places to sit and wonder about the past.

### 5. Deckadence.



Small decks provide platforms that can transform into explorer's ships or castle towers.

6. A Mazing



A painted path-way that connects and confounds.

7. Wall Art



A long wall where students can create chalk art.

8. Edible Garden

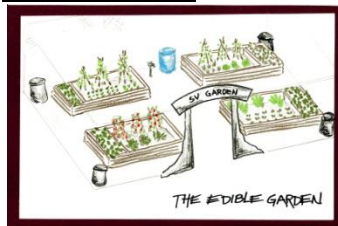

An enclosed vegetable garden will create learning experiences with the planting, care and harvesting of plants.

9. The Gravel Stream



An imaginary gravel stream where students play

10. Over Hill And Dale.

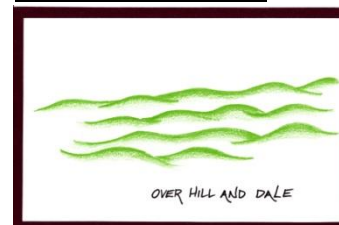

An area with small hills so that students can experience different movement while they climb and play.

